

EXTREME

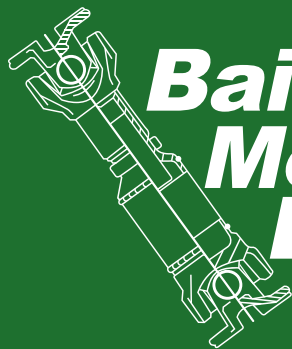

**Bailey
Morris
Limited**

www.baileymorris.co.uk

ABOUT BAILEY MORRIS

Established in 1977, Bailey Morris Ltd is the U.K's foremost specialist propshaft company. With facilities in both Cambridgeshire and West London (Feltham), we can ensure that our extensive stock provides the widest choice of leading brand products sourced from the world's foremost original equipment component manufacturers.

MANUFACTURING

- Wide range of propshafts for all applications. HGV, LCV, classic car, motorsport, 4x4, engine test cells, industrial, marine, off-highway and construction.
- Flexible capacity caters for single shafts and batch work
- Service includes new propshafts, repairs, remanufacture, modification and upgrades.
- Original equipment, aftermarket and custom build options.
- 'All-Makes' propshaft programme

DISTRIBUTION

- Comprehensive stock range covering 'All-Makes' propshafts and components
- Fast and efficient distribution service covering the U.K. and worldwide.
- Original equipment and aftermarket options available
- Centre bearings, universal joints, flange yokes, slip-assemblies, coupling flanges and propshaft specification tube
- No order too big or too small



WHY CHOOSE EXTREME?

HIGHER TORQUE CAPACITY

Our 'Extreme' shafts are upgraded to increase the torque capacity compared to standard units. Options available to increase the capacity up to 28%.

UPGRADED SLIDING ASSEMBLY

Each shaft is fitted with an upgraded, involute spline configuration. Sliding assemblies are fitted with robust sealing (to keep the dirt out) and increase maximum slip length by up to 100%.

HEAVY DUTY UNIVERSAL JOINTS

Our universal joints are selected for their sealing specification to keep out water and dirt. Tried and tested on multiple terrains and weather conditions:

WIDE ANGLE OPERATION

Every 'Extreme' shaft is machine to achieve higher angles of operation. Flexing up to 30° to compensate for increased suspension activity.

DOUBLE CARDAN JOINTS

Available for applications in which the flanges on the vehicle can't be kept parallel; our double joint assembly assist in achieve the offset in angles.

HEAVY DUTY TUBING

Which ever 'Extreme' propshaft you buy, it will come with heavy duty tubing as standard to cope with the strain of off-roading.



EXTREME PRODUCTS



EXTREME I

The original '**Extreme**' shaft. Comes with all the '**Extreme**' features as standard without the Double Joint Assembly.

Part Number	Price
31AS-9	£226.80 inc VAT



EXTREME II

The upgraded version of the '**Extreme I**' shaft. Higher torque capacity and heavier duty tubing as standard.

Part Number	Price
35AS-4	£318.00 inc VAT



EXTREME DOUBLE CARDAN

The double jointed version of the '**Extreme I**'. All other features '**Extreme**' as standard.

Part Number	Price
31AS-26/1	£425.60 inc VAT



ULTIMATE EXTREME

Our highest spec '**Extreme**' shaft. Higher torque capacity than the '**Extreme** Double Cardan'.

Part Number	Price
2020AS-32	£478.80 inc VAT

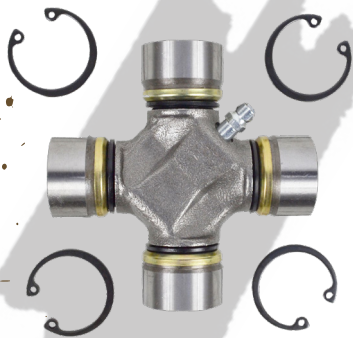

EXTREME UNIVERSAL JOINT

The '**Extreme**' UJ used in our '**Extreme I**' and '**Extreme Double Cardan**' shafts. Comes with greasing points.

Part Number	Price
BM50/2	£14.99 inc VAT

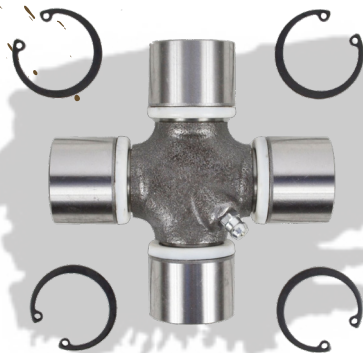

EXTREME II UNIVERSAL JOINT

The '**Extreme II**' UJ used in our '**Extreme II**' shafts. Comes with greasing point and triple sealing.

Part Number	Price
BM73/1	£15.99 inc VAT



ULTIMATE EXTREME UNIVERSAL JOINT

The 'Ultimate Extreme' UJ used in our 'Ultimate Extreme' shafts. Comes with greasing point.

Part Number	Price
BM844	£21.99 inc VAT



EXTREME SERVICE PACK

A kit which includes two universal joints, a tube of grease, flange bolts and a propshaft fastener tool.



Part Number	Price
Service Pack	£69.99 inc VAT



GREASE

Bailey Morris approved grease for your 'Extreme' shaft. Ensuring your prop is properly greased extends its life.

Part Number	Price
Grease/4	£7.99 inc VAT



PROPSHAFT FASTENER TOOL

Propshaft fastening tool for the flange bolts so you can swap the original shaft with you **'Extreme'** one with ease.

Part Number	Price
BM-LRT/1	£19.99 inc VAT



PROPSHAFT FLANGE BOLT KIT

A propshaft flange bolt kit suitable for use with our **'Extreme'** shafts. (4 bolts/8 nuts)

Part Number	Price
BK-16	£3.99 inc VAT





LAND ROVER



NISSAN



TOYOTA & MORE

INTRODUCING...

GREASABLE EXTREME DOUBLE JOINT

The new greasable 'Extreme' double joint is available from Spring 2019! Each unit includes greasing points on the end of a universal joint cap and on the housing of the ball joint. Created for ease of access for both universal joints and the ball joint. Call or email Bailey Morris Ltd to find out more!



TECHNICAL

- Bailey Morris Extreme shafts are built as a direct replacement for your original shaft. If your original shaft set up differs from the original spec, please inform our sales team.
- Whilst the most common application we see is Land Rover, we are able to offer an upgrade for most vehicle types. Please don't hesitate to ask.
- All of our shafts are custom built to order to ensure that you get the right shaft for your vehicle. When ordering your shaft, please check the required measurements on your vehicle.
- It may not be necessary for you to have a double jointed shaft. It is only necessary to fit one if the flanges on your vehicle are not parallel. In our experience, it is only necessary to fit a double cardan shaft on the front on some applications.
- Whilst the shafts we supply are greased, we recommend regulary checking the universal joints are fully greased.

IF IN DOUBT, ASK!

EXTREME

By Bailey Morris Ltd

"Extreme" Wide Angle Landrover Propshaft

1

MEASURE

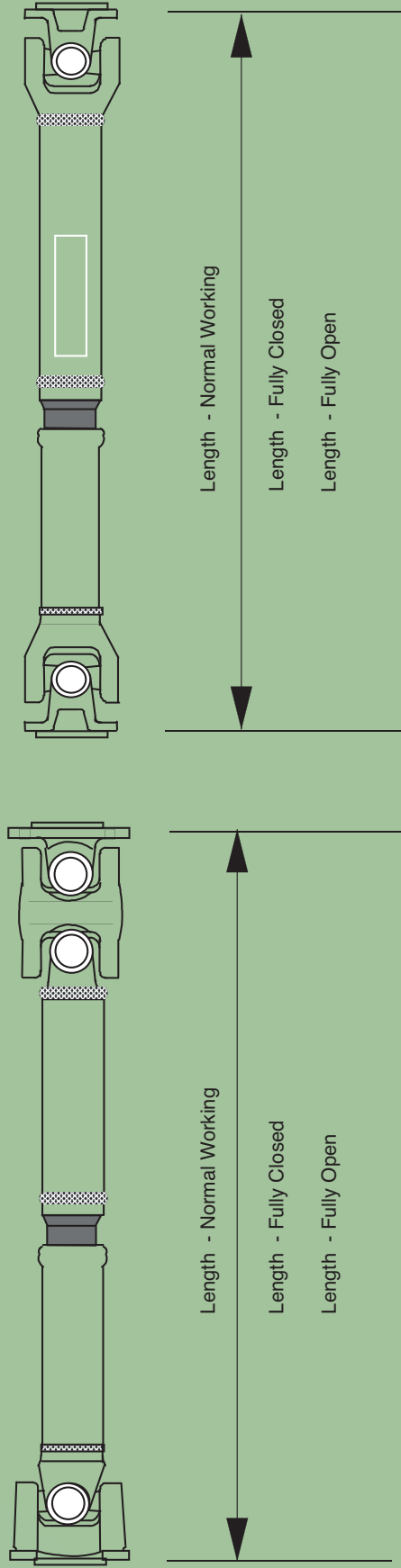

Wide Angle 30°

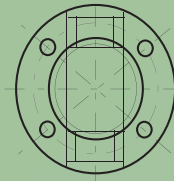

97mm Dia. Flange (1310case)
With 60.3mm Dia. Male Register And
4 X 9.8mm Bolt Holes
On 79.4mm P.C.D
Holes Not Equally Spaced

Double Knuckle Flange 30°

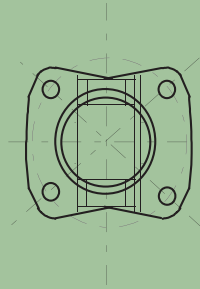

95mm Pcd Flange
With 65mm Dia. Male Register And
4 X 10.3mm Bolt Holes
Holes Equally Spaced 67mm X 67mm

Double Knuckle Flange 30°
(Same As Slip End)

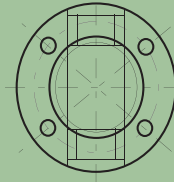

97mm Dia. Flange (1310case)
With 60.3mm Dia. Male Register And
4 X 9.8mm Bolt Holes
On 79.4mm P.C.D
Holes Not Equally Spaced

Phasing - Zero Degrees + / - 1 Degree
Weld - Mig
Straightness - 0.10 Axis X / 0.20 Axis Y
Dynamic Imbalance - Vdi2060 Q16 Max (Iso 1940) 2500 R.P.M



2

CHOOSE COLOUR



RED



BLUE



GREY



BLACK



YELLOW



GREEN



3

PLACE YOUR ORDER



EMAIL: SALES@BAILEYMORRIS.CO.UK

CALL: +44(0)1480 216250

FAX: +44(0)1480 403045

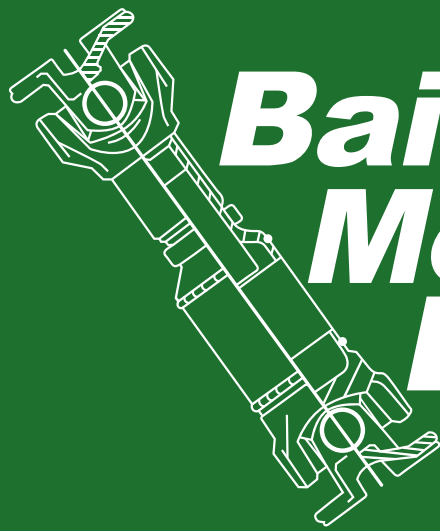

Bailey Morris Limited



**www.baileymorris.co.uk
+44(0)1480 216250
sales@baileymorris.co.uk**

8 Little End Road, St Neots, Cambs, PE19 8GE